



# Andela

## TWIN BARREL

### Andela GP-2HD Glass Pulverizer

**Model:**  
GP-2HD: 20 TPH

**Designed for High  
Capacity Applications**

**Flexible Impact  
Hammers**

*Reduces waste  
Provides a cost effective remedy  
for environmentally conscious  
communities*

#### ANDELA PRODUCTS

493 State Route 28  
Richfield Springs, NY 13439

Phone: (315) 858-0055

[www.andelaproducts.com](http://www.andelaproducts.com)  
[info@andelaproducts.com](mailto:info@andelaproducts.com)



- Selective size reduction produces a glass sand, and glass aggregate, while leaving non glass residue in-tact for ease of separation
- Machine design features access doors with bolt in replacement liners and hammers for hassle free maintenance and service
- Generates safe handling glass product with no sharp edges suitable for a variety of applications
- Quiet Operation
- Simple to Operate and Maintain
- Low Horsepower
- Reasonably Priced
- Durable
- Bolt in Liners and Hammers for Easy Maintenance.
- Processes whole glass bottles and/or MRF glass

**ANDELA GLASS PULVERIZER**  
**MODEL GP-2HD**  
**20 tons/hr. capacity**

**MACHINE SPECIFICATIONS**

Dimensions

Overall Length .....Approx. 88"  
Overall Width .....Approx. 79"  
Infeed Hopper Opening .....36" x 36"  
Machine Input Opening .....20" x 20"  
Input Chamber Diameter and Length .....30" x 44"  
Output Chamber Diameter and Length .....30" x 58"  
Chamber Type.....Steel Frame & Heavy Duty Support Stand  
Liners ..... Bolt-in Heavy Duty Abrasion Resistant Steel  
Heavy Duty Frame with Vibration Isolation .....(5) Mechanical Spring Isolators

Drive Componentry

Motor Size .....Two (2) 20 HP TEFC  
Solid Steel Shaft Diameter .....3" Dia.  
Number of Hammers .....56  
Hammer Type ..... Flexible Impactor/Hardened Steel  
Bearing Size..... 3" Heavy Duty  
Seal Protection..... Two (2) Seals At Each Shaft Bearing

Safety Features

Protective Guards ..... Cover Input Hopper, Drive Unit and Bearings  
Access Doors.....Hammer and Liner Maintenance

Electrical

Motor Voltage .....230/460 VAC, 60 HZ, 3 phase

Weight

Static Weight .....7,500 lbs.

The manufacturer reserves the right to change designs  
and specifications without notice.



# Andela

## Hoppers

### Surge Hopper

**Evenly Distributes  
Material**

**Essential for Bulk  
Loading**

**Models:**

AMSH86-18

AMSH86-24

*Environmentally friendly*

*Reduces waste*

*Provides cost effective remedy  
for environmentally conscious  
communities*

**ANDELA PRODUCTS**

493 State Route 28  
Richfield Springs, NY 13439

Phone: (315) 858-0055

[www.andelaproducts.com](http://www.andelaproducts.com)  
[info@andelaproducts.com](mailto:info@andelaproducts.com)



- The Andela Metering Surge Hopper is designed to accept bulk loading of glass or other materials
- Holds 4 cubic yards, or up to 6 cubic yards with optional flared extensions (shown in picture)
- Reciprocating plate feeder meters the flow rate of material into the system
- Adjustable slide gate regulates whole, or mixed broken glass to desired throughput

- Simple to Operate & Maintain
- Easy Installation
- Reasonably Priced
- Heavy Duty Construction
- 18" or 24" wide Discharge
- Abrasion Resistant Materials on All Wear Surfaces

---

**ANDELA METERING SURGE HOPPER**  
**MODEL AMSH86F-18**  
**with flared sides**

**MACHINE SPECIFICATIONS**

Dimensions

Capacity..... 6 to 7 cubic yds.  
Overall Length .....125"  
Overall Width .....101"  
Overall Height .....111"  
Discharge Opening .....18" wide x Adjustable Height  
Discharge Height .....40"

Drive Componentry

Motor Size .....(1) 3 hp  
Direct Drive System ..... Totally Enclosed Gear Reducer  
.....Reciprocating Plate with Eccentric Drive

Electrical

Motor Voltage..... 230/460 VAC, 60 HZ, 3 Phase  
(VAC and HZ provided to customer specifications)

Selected surfaces hardened for long wear and durability.

The manufacturer reserves the right to change designs  
and specifications without notice.



## **Andela Reciprocating Plate Feeder**

The Metering Surge Hopper is a stand alone unit with an active mechanical plate feeder that will accept bulk quantities of glass and discharge the glass at a metered flow rate into the glass pulverizer.

The top of the hopper is eight feet by six feet wide and will accept up to four cubic yards of glass ready for processing. Flared extensions are an available option for added capacity of up to six cubic yards. The hopper is welded steel construction and completely lined with abrasion resistant steel plate to withstand the wear associated with the loading of broken glass.

The reciprocating plate feeder feeds the glass out the front of the hopper onto the pulverizer infeed conveyor. An adjustable door on the front of the hopper is used to select the feed rate appropriate for the processing capacity of the system. The plate feeder has unidirectional teeth that pre-break whole bottles as it reciprocates and discharges the broken glass.





# Andela

## Conveyors

Belt Width Options:  
18", 24", 30" & 36"

Variable Lengths, Bed  
Types, & Pans Available.

Stainless Steel Sections  
for Crossbelt Magnets

### Conveyor Types:

Slider Bed  
Troughing Roll

### Belt Tread Type:

Cleated belt  
Smooth belt  
Chevron belt



### ANDELA PRODUCTS

493 State Route 28  
Richfield Springs, NY 13439

Phone: (315) 858-0055

[www.andelaproducts.com](http://www.andelaproducts.com)  
[info@andelaproducts.com](mailto:info@andelaproducts.com)

- Andela Conveyors are available in various sizes and configurations to fit any application
- Remote grease fittings and lines extend to base of conveyor for ease of maintenance

- **Increases Production**
- **Less Handling of Material**
- **Heavy Duty Construction**

---

## **ANDELA SYSTEM CONVEYORS** **MACHINE SPECIFICATIONS**

### **Heavy Duty – Troughing**

<b>Overall Length/Width</b>	According to Quotation
<b>Drive System</b>	3-phase motor and gear reducer, direct drive
<b>Conveyor Body</b>	10" x 3/16" formed steel channels
<b>Carry Surface:</b>	Troughing Roller
<b>Belt</b>	Smooth, chevron or cleated rubber belt
<b>Head Pulley</b>	10" head pulley
<b>Tail Pulley</b>	10" self cleaning tail pulley
<b>Take Up</b>	Adjustable Side Mounted bearings with 1 15/16" bore.
<b>Returns</b>	Return rolls with smooth and chevron belts Belly pans with wear resistant glides for cleated belt
<b>Hopper/Sides/</b>	Formed 10 gauge painted steel

The manufacturer reserves the right to change designs  
and specifications without notice.



# Andela

## Trommel

### Trommel Screener

30" & 48" diameters

6ft–15ft long

1.5 HP–7.5 HP

3 material separations

1 or 2 aggregate sizes

1 oversize / residual

#### Various Applications

Glass

Compost

Plastics

Rubber

Gravel

Mixed Material

#### ANDELA PRODUCTS

493 State Route 28  
Richfield Springs, NY 13439

Phone: (315) 858-0055

[www.andelaproducts.com](http://www.andelaproducts.com)  
[info@andelaproducts.com](mailto:info@andelaproducts.com)



The Andela Trommel Screen Separator is designed to separate and size aggregate using woven wire mesh or perforated plate.

Our trommels feature direct drive systems flexibly mounted with totally enclosed gear reducers for long lasting performance.

Comes equipped with rotating brushes for cleaning the screens.

Customizable chutes build to customer specification.

- Simple to operate and maintain
- Easy Installation
- Reasonably priced
- Durable
- Totally enclosed with easy access doors
- Single frame construction



**ANDELA TROMMEL SEPARATOR**  
**MODEL ATROM-105**  
**THREE SCREEN**

**MACHINE SPECIFICATIONS**

Screen Sizes

Screen #1 .....3/16" screen opening or to specification  
.....48" OD x 5' long  
Screen #2 .....3/16" screen opening or to specification  
.....48" OD x 5' long  
Screen #3 .....7/16" screen opening or to specification  
.....48" OD x 5' long

Categories of Separation

3/16" minus – glass sand (or to specification)  
3/16" – 7/16" – glass gravel (or to specification)  
7/16" plus - residue

Features

Overall Length .....Approx. 21 ft  
Overall Width .....Approx. 6 ft  
Enclosure .....Complete Sheet Metal Enclosure  
.....Hinged Service Door for Screen & Brushes  
Screen Barrel Diameter and Length .....48 in x 17 ft  
Screen Type .....Stainless Steel Woven Wire  
Rotating Brushes .....(3) – 7 in diameter  
Maintenance Features .....Central lubrication Block, External Mount

Drive Componentry

Motor Size .....(1) 7.5 hp  
Direct Drive System .....Totally Enclosed Gear Reducer  
.....Flexible Mount

Electrical

Motor Voltage .....230/460 VAC, 60 HZ, 3 Phase

The manufacturer reserves the right to change designs  
and specifications without notice.

## **Electrical Control Panel**

**Enclosures** - Enclosures are rated per the environment and are NEMA 4 or better. All enclosures are supplied with an emergency stop.

**Main Disconnect** - The main disconnect is provided with fuses or a circuit breaker and has a “Lockout/Tagout” feature.

**Motor Starters** - The motor starters are IEC rated.

**Branch Circuit Protectors** - The Branch circuit protectors are provided with a circuit breaker and a motor overload as an integral part of the unit.

**Push Buttons** - All push buttons are Heavy Duty dust tight/water tight design.

**Standards** - Built to UL-508 Industrial Standards. Electrical schematics and parts lists are supplied with the unit when the whole system is shipped. Can be CE certified upon request.

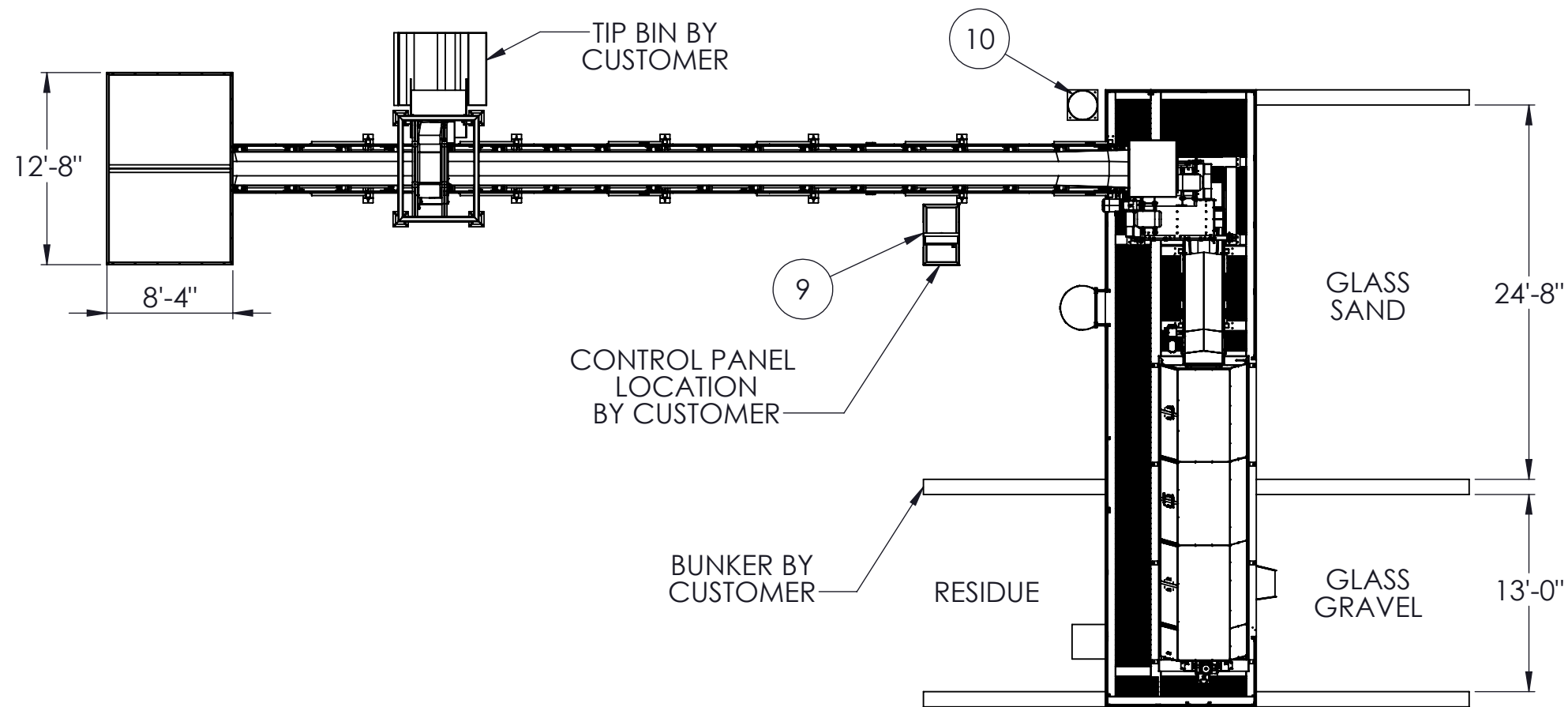

ITEM NO.	DESCRIPTION	Hp
1	AMSH812x24	5 Hp
2	30x70 GP-2HD Infeed Conveyor	7.5 Hp
3	Magnet	3/4 Hp
4	GP-2HD Pulverizer	2 @ 20 Hp
5	24x12 105 Infeed Conveyor	1.5 Hp
6	105 Trommel	7.5 Hp
7	Destoner	1 Hp
8	Service Platform	N/A
9	Control Panel	N/A
10	Misting System	1/12 Hp

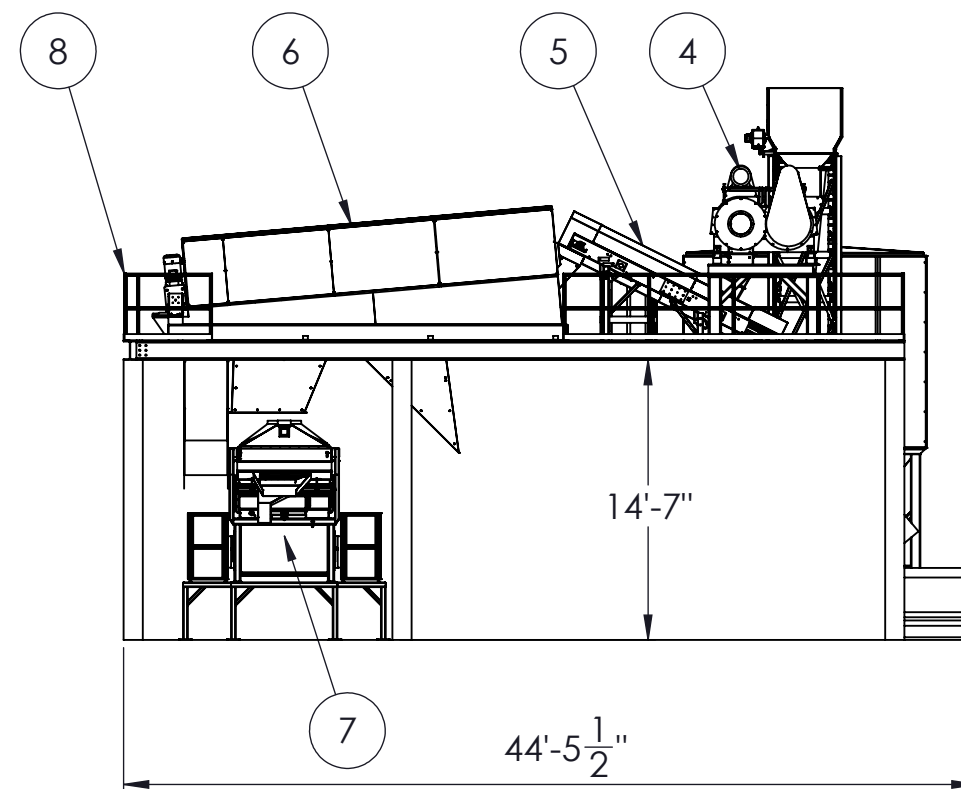
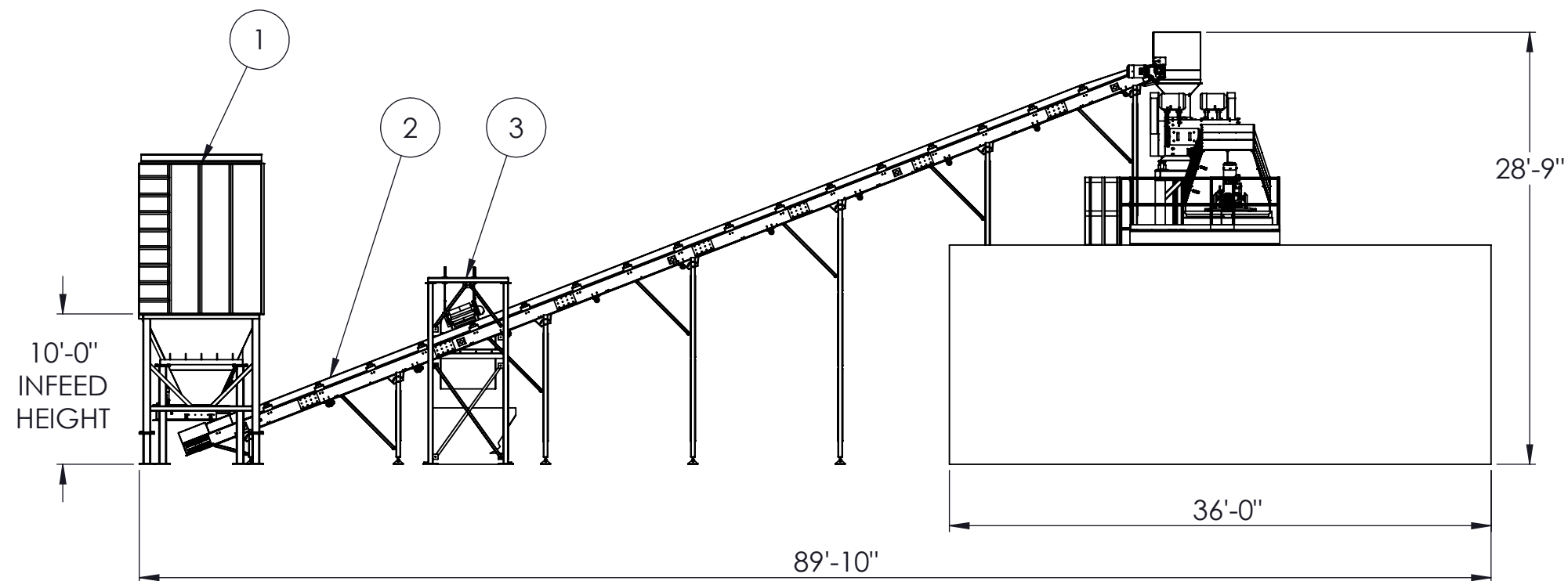

493 State Route 28  
Richfield Springs, NY 13439

tel: 315-858-0055  
fax: 315-858-2669

DRAWN  
BMT  
DATE  
01/22/20  
CHECKED  
XXX  
DATE  
XXX  
SCALE  
1 : 120

## GP-2HD SYSTEM WITH DESTONER

REVISION	DATE
X XXX	XXX XX/XX/XX

FILE NO

OC-000

SHEET 1 OF 1

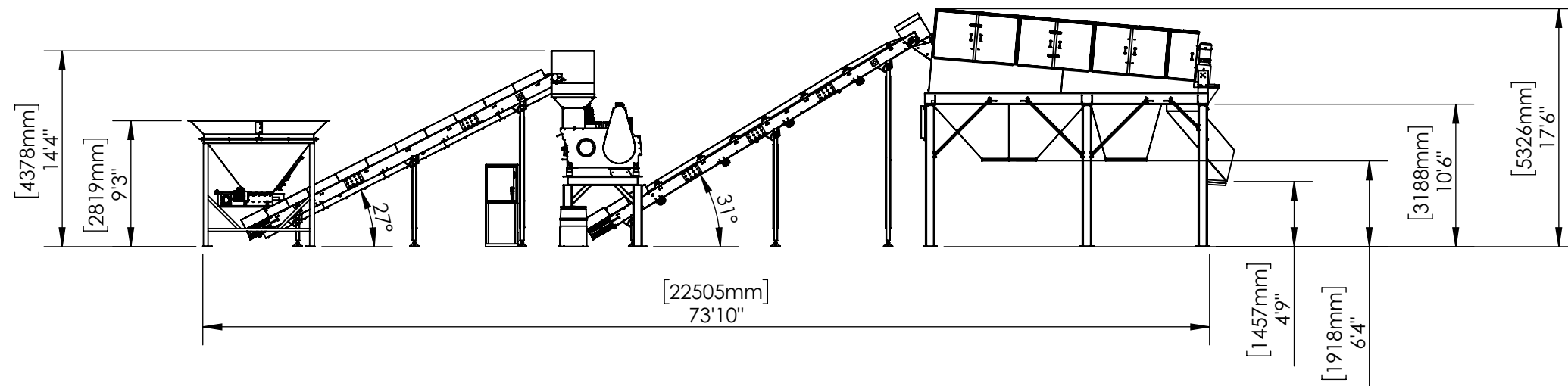
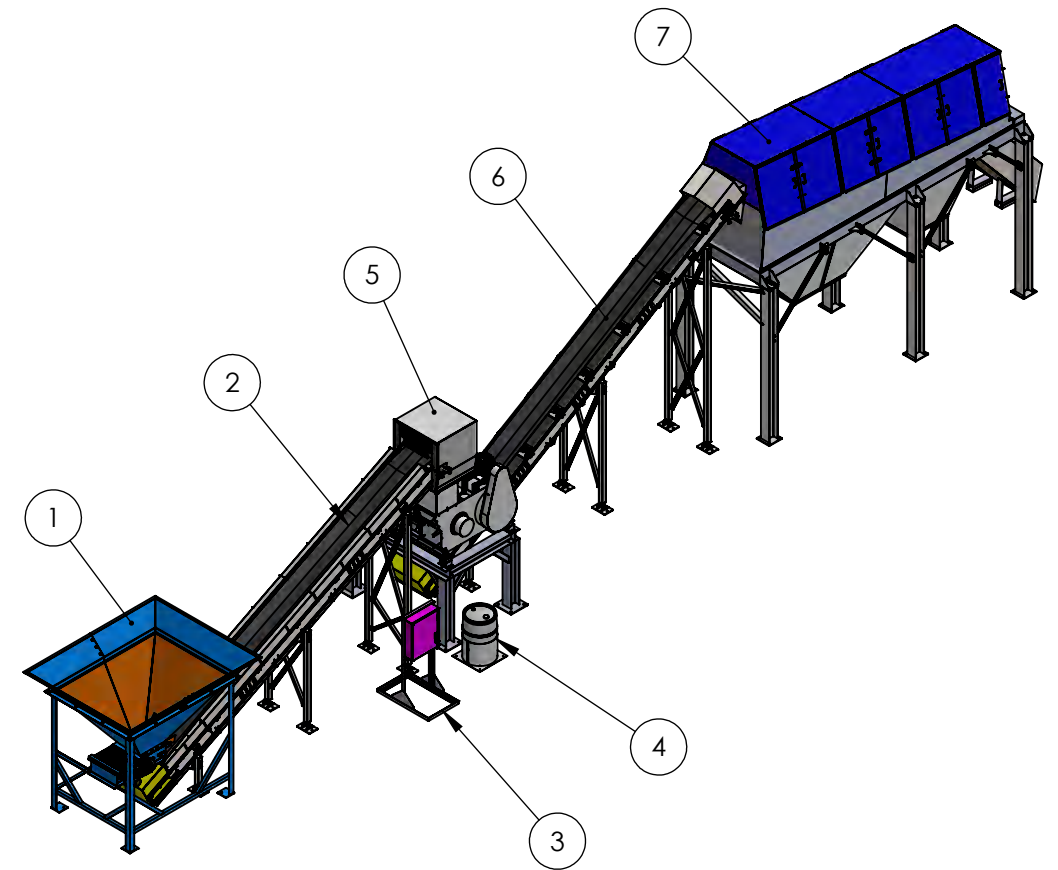
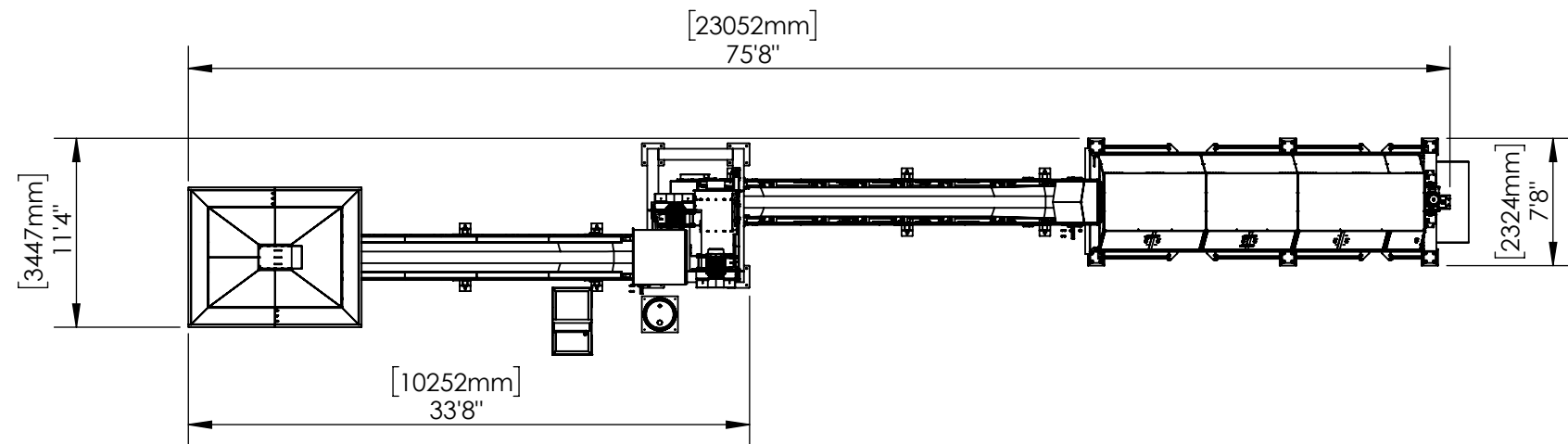

- 1) COLOR: RAL-5015 BLUE WITH SAFETY YELLOW GUARDS.  
DIFFERENT COLORS AVAILABLE BY CUSTOMER REQUEST
- 2) ALL DIMENSIONS ARE REFERENCE DIMENSIONS AND MAY  
VARY PER CUSTOMERS SPECIFICATIONS.
- 3) CONTROL PANEL AND MISTING SYSTEM BARREL LOCATIONS  
ARE TO BE DETERMINED BY CUSTOMER.

ITEM	DESCRIPTION	H/P	QTY.
1	AMSH86-18 SURGE HOPPER	3 HP	1
2	24" X 26FT CONVEYOR	3 HP	1
3	CONTROL PANEL	N/A	1
4	OPTIONAL MISTING SYSTEM	1/12 HP	1
5	GP2 GLASS PULVERIZER	2 @ 20 HP	1
6	24" X 28FT CONVEYOR	3 HP	1
7	ATROM 105 TROMMEL	7.5 HP	1



493 State Route 28  
Richfield Springs, NY 13439

Tel: 315-858-0055  
andelaproducts.com

DRAWN JEA
DATE 5/11/2021
CHECKED
DATE
SCALE 1:128

GP2-105 SYSTEM  
GP2 GLASS PULVERIZER AND 105  
TROMMEL SYSTEM

ANDELA PRODUCTS

REVISION	DATE

FILE NO
GP2-105
SHEET 1 OF 1

**NOTE**  
 DETAILING, PRODUCTION, AND  
 COMPONENT PURCHASING WILL NOT  
 BEGIN UNTIL ONE (1) SET OF DRAWINGS  
 HAS BEEN APPROVED, SIGNED, AND  
 RETURNED TO ANDELA PRODUCTS

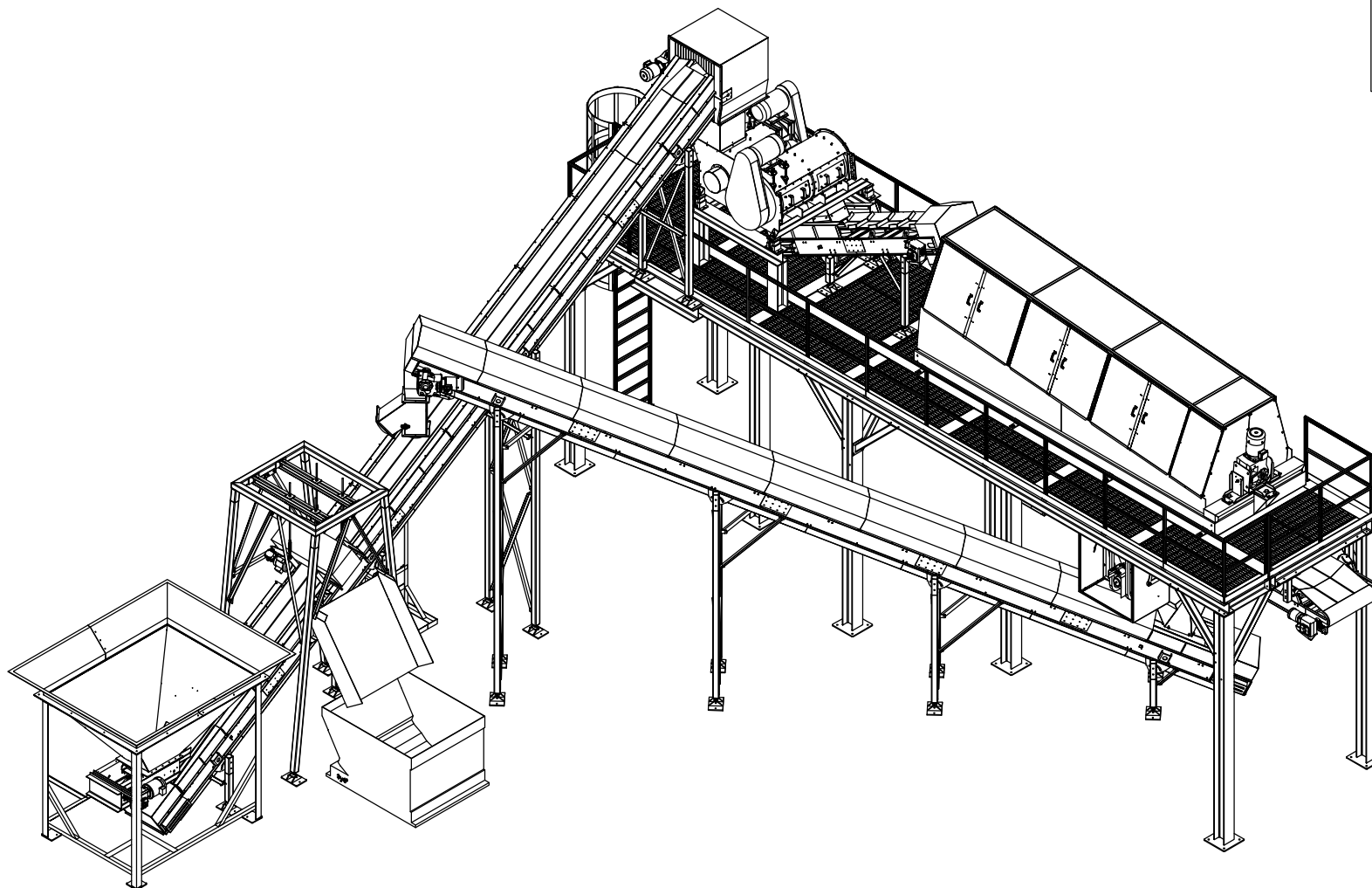

493 State Route 28  
 Richfield Springs, NY 13439

tel: 315-858-0055  
 fax: 315-858-2669

DRAWN  
 VTB  
 DATE  
 2/24/16  
 CHECKED  
 DATE  
 SCALE  
 1:50

## GP2-HD/105 SYSTEM LAYOUT

REVISION		DATE
C	Added diverter on #8	VTB 4/10/16
D	Added Covers to conveyors #3 & 8	VTB 6/30/16

FILE NO

**SWC-00**  
 SHEET 4 OF 5



NOTE  
 DETAILING, PRODUCTION, AND  
 COMPONENT PURCHASING WILL NOT  
 BEGIN UNTIL ONE (1) SET OF DRAWINGS  
 HAS BEEN APPROVED, SIGNED, AND  
 RETURNED TO ANDELA PRODUCTS

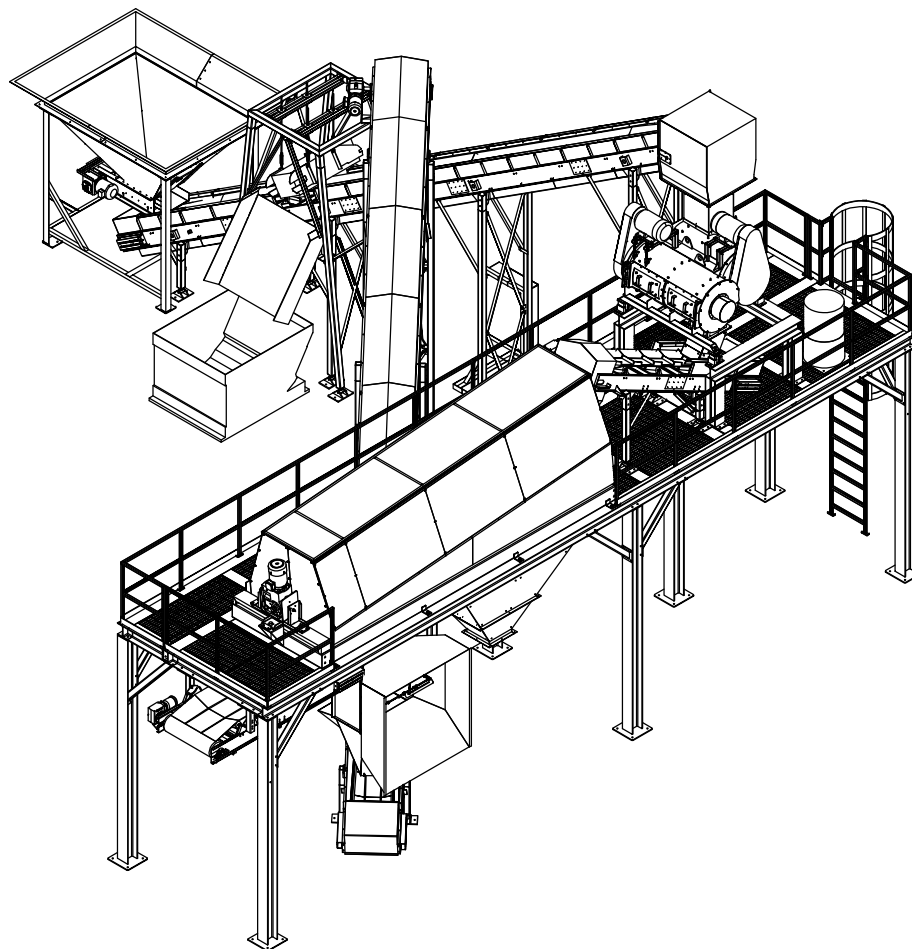

493 State Route 28  
 Richfield Springs, NY 13439

tel: 315-858-0055  
 fax: 315-858-2669

DRAWN  
 VTB  
 DATE  
 2/24/16  
 CHECKED  
 DATE  
 SCALE  
 1:70

## GP2-HD/105 SYSTEM LAYOUT

REVISION		DATE
C	Added diverter on #8	VTB 4/10/16
D	Added Covers to conveyors #3 & 8	VTB 6/30/16

FILE NO

**SWC-00**  
 SHEET 5 OF 5