



Andela

AGB-06HD

AGB-06 HD Glass Crusher

5 TPH

Efficient Size Reduction

Flexible Impact Hammers

Product Destruction

Glass Cullet Processing

**Commingled Container
Processing & Separation**

Model:

AGB-06: 5 TPH

*Reduces waste
Provides a cost effective remedy
for environmentally conscious
communities*

ANDELA PRODUCTS

493 State Route 28
Richfield Springs, NY 13439

Phone: (315) 858-0055

www.andelaproducts.com
info@andelaproducts.com



- The Andela AGB-06HD Glass Crusher is used for glass cullet production or to efficiently reduce and separate mixed glass from a commingled mix of glass, plastic and aluminum.
 - The flexible impact hammers will liberate and crush glass, ceramics and other breakable materials.
 - Specifically designed, engineered, and outfitted with select abrasion resistant materials to endure the rigors of glass processing.
 - Also available as a system
(See Systems Page)
- Simple to operate and maintain
 - Low power requirements for significant size reduction
 - Will process a mix of glass and other materials — selective size reduction
 - Big machine features with a small machine price
 - Heavy duty construction

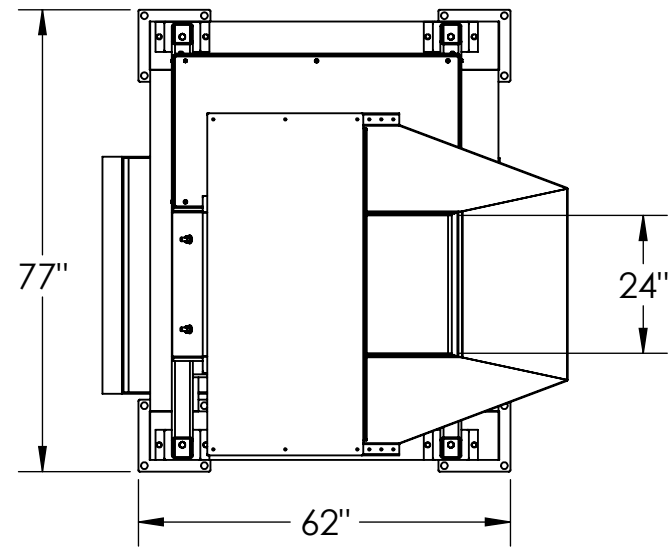

**THIS DRAWING IS INTENDED FOR PROPOSAL PURPOSES
ACTUAL DESIGNS, DIMENSIONS AND DETAILS MAY VARY AFTER
DETAILING AND FINALIZATION**

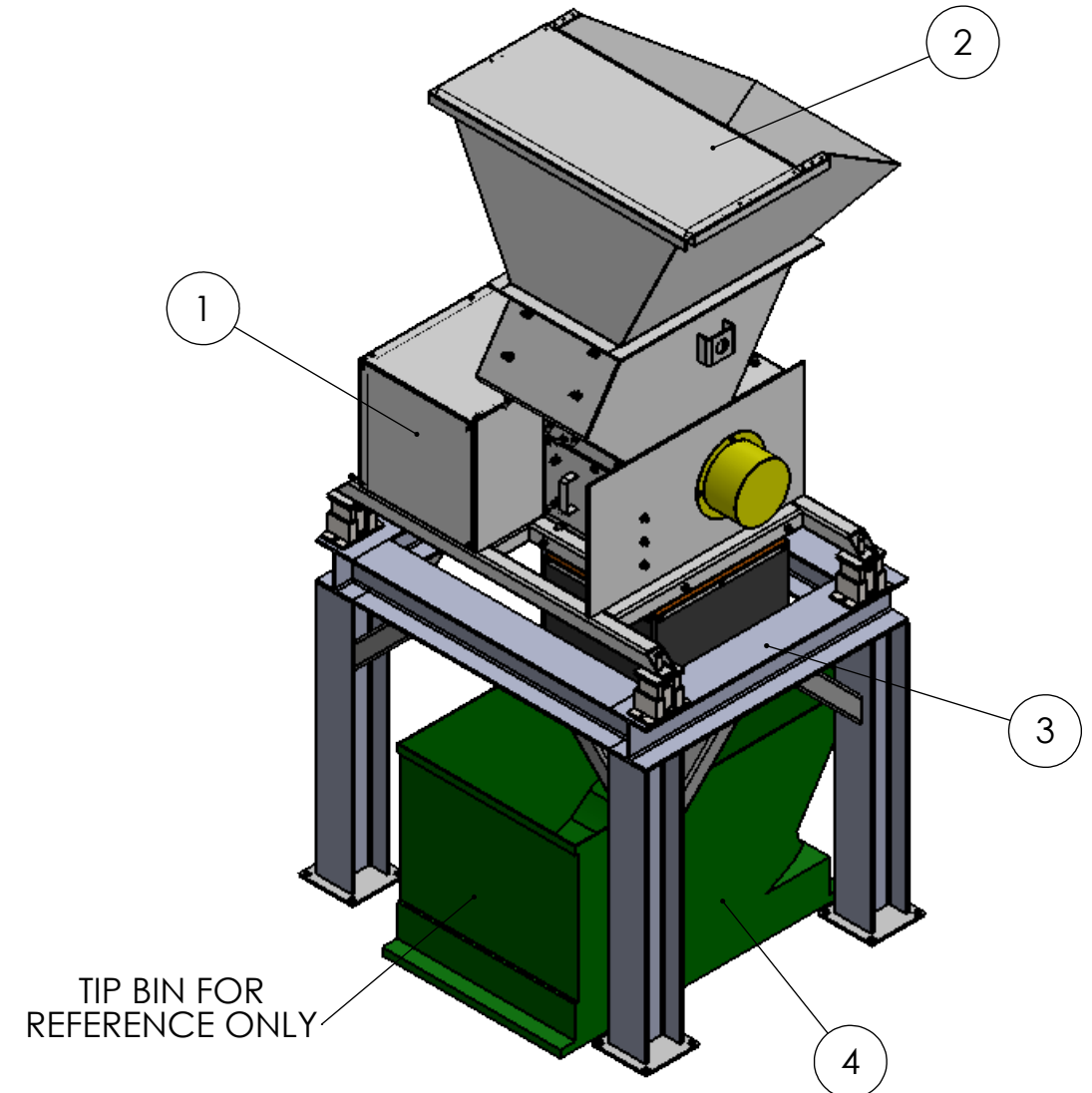
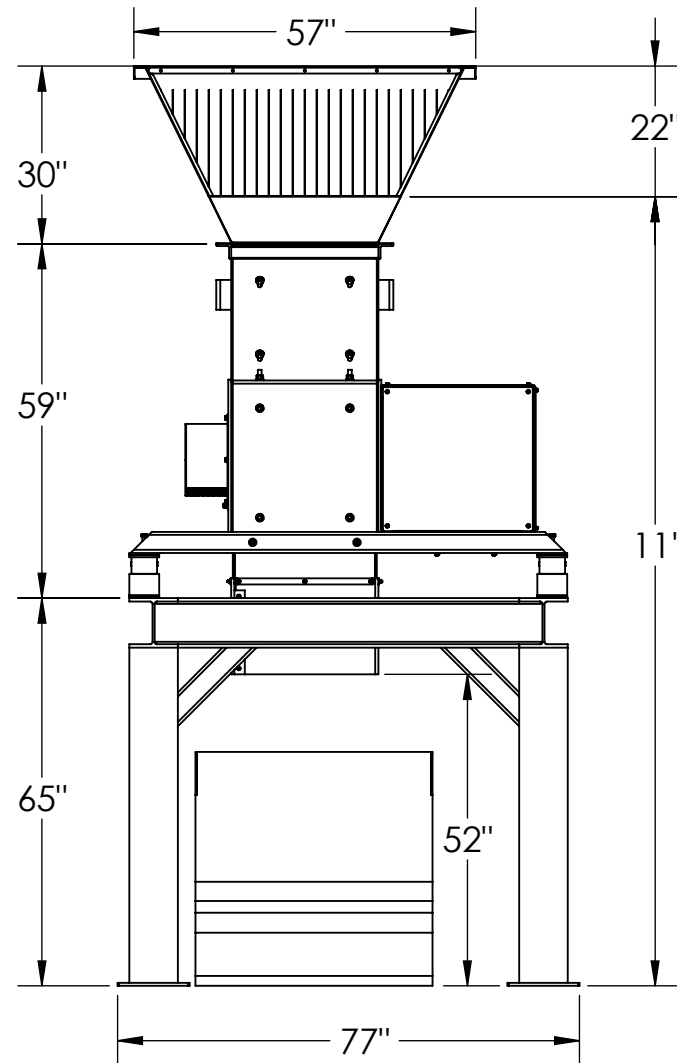
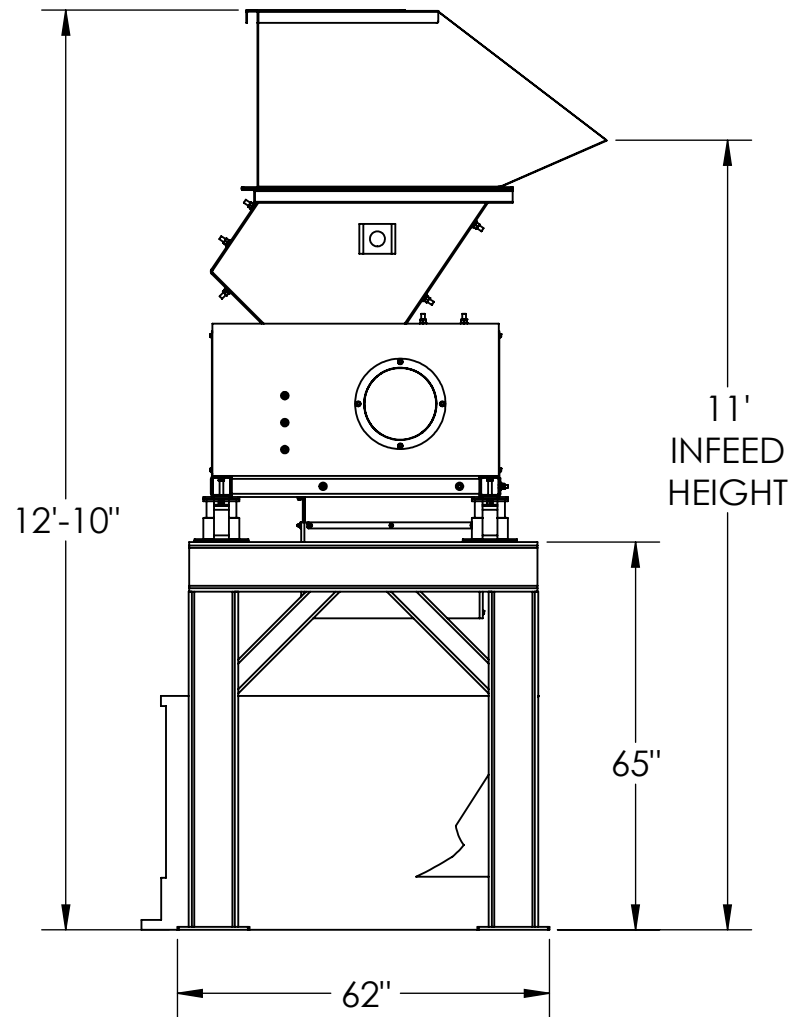

AGB6-STD GLASS BREAKER on STAND		
ITEM NO.	DESCRIPTION	H.P.
1	AGB6 GLASS BREAKER	7.5 HP
2	INFEED HOPPER W/ ADJ. COVER	N/A
3	AGB6 STAND	N/A
4	CUSTOMER PROVIDED TIP BIN	N/A



493 State Route 28
Richfield Springs, NY 13439
Tel: 315-858-0055
andelaproducts.com

DRAWN BY:
RJY
MODELED BY:
RJY
DATE:
10/13/2023
CHECKED BY:
SCALE
1:48

**AGB6-STD
STANDARD GLASS BREAKER on STAND**

ANDELA PRODUCTS

ALL EQUIPMENT PAINTED RAL-5015 SKY BLUE,
ALL GUARDS AND RAILINGS PAINTED RAL-
1023 TRAFFIC YELLOW, AND ALL PLATFORMS
PAINTED RAL-9017 TRAFFIC BLACK, UNLESS
OTHERWISE NOTED.

AGB6-STD

SHEET 1 OF 1



www.andelaproducts.com

ANDELA BREAKER MODEL AGB-06HD

The Andela Breaker is ideally suited to many applications because of its durability, flexibility, and design. This equipment is unique in its ability to successfully process a broad range of items using a technology that selectively reduces certain material while leaving others whole.

MACHINE SPECIFICATIONS

Dimensions

Overall Length	62"
Overall Width	77"
Overall Height	Variable
Input Opening	36" x 24"
Frame Construction	Welded Steel with 1/4" to 3/4" Thick Abrasion Resistant Replaceable Bolt In Steel Liner Plates Heavy Duty Frame with Vibration Isolation (4) Mechanical Spring Isolators

Drive Componentry

Motor Size	(1) 7.5 hp
Solid Steel Shaft Diameter	2-1/2"
Number of Hammers	12
Hammer Type	Heavy Duty Flailing Arm of Through Hardened Steel
Bearing Size	2-1/2"

Safety and Maintenance Features

Protective Guards	Cover Input Drive Unit and Bearings
Access Door	Removable Panels for Hammer and Liner Maintenance

Electrical

Motor Voltage	230/460VAC, 60 HZ, 3 Phase (or to customer specifications)
---------------------	---

The manufacturer reserves the right to change designs and specifications without notice.